

FARMA C 6.7 G3



FARMA CT 6.7-9F

The trailer and crane in the photo are fitted with extra equipment.

TECHNICAL SPECIFICATION

Technical data	C 6.7 G3
Lift capacity net (kNm)	27
Slewing torque (kNm)	10
Slewing angle (degrees)	360
Reach (m)	6.7
Telescopic stroke length (m)	1.45
Recommended Oil flow (l/min)	20-50
Working pressure (MPa)	19.0
Lifting force full length (excl. grapple/rotator) (kg)	405

For additional information about crane sizes, movement patterns and specifications please refer to the matrix and technical data in this brochure and to www.forsmw.com, where detailed information is available.

OUR BESTSELLER T9 IS NOW BETTER WITH NEW C6.7 G3 CRANE

The brand new FARMA C6.7 G3 is a longer and stronger crane in our medium-sized forestry cranes range that meets all the requirements of the timber handling. Entirely new telescopic mechanism, hidden hoses and the terrific working geometry of the boom give good performance in your forestry work. The crane is made of high strength steel to give the best strength and low self-weight to support a higher payload.

C6.7 G3 comes with a new powerful 10 kNm turnhouse that is 30% stronger in slewing and has a better design compared to previous turnhouses. We call these new cranes G3 as they offer so many benefits to the user.

The lift cylinder is well protected behind the railing and the focus is on being easy to maintain. The new design ensures the crane is more hard-wearing and maintenance friendlier. FARMA C6.7 G3 has a reach of 6.7 m and is equipped with a single 1.5 m extension. At full length it lifts 405 kg. Get the most of your FARMA crane and also check our large range of accessories.

C6.7 G3 crane is suitable with our updated bestsellers **T9F, T9F 4WD, T10F, T10F 4WD, T10 G2*** FARMA trailers. New mounting solution gives better stability since the centre of gravity is lower. This means better stability and visibility for the operator. The support legs are boltable, so the customer can choose between telescopic (standard) or flap down (as extra) legs.

* We do not offer telescopic support legs as an option for FARMA T10 G2 trailer.

MAIN DIMENSIONS

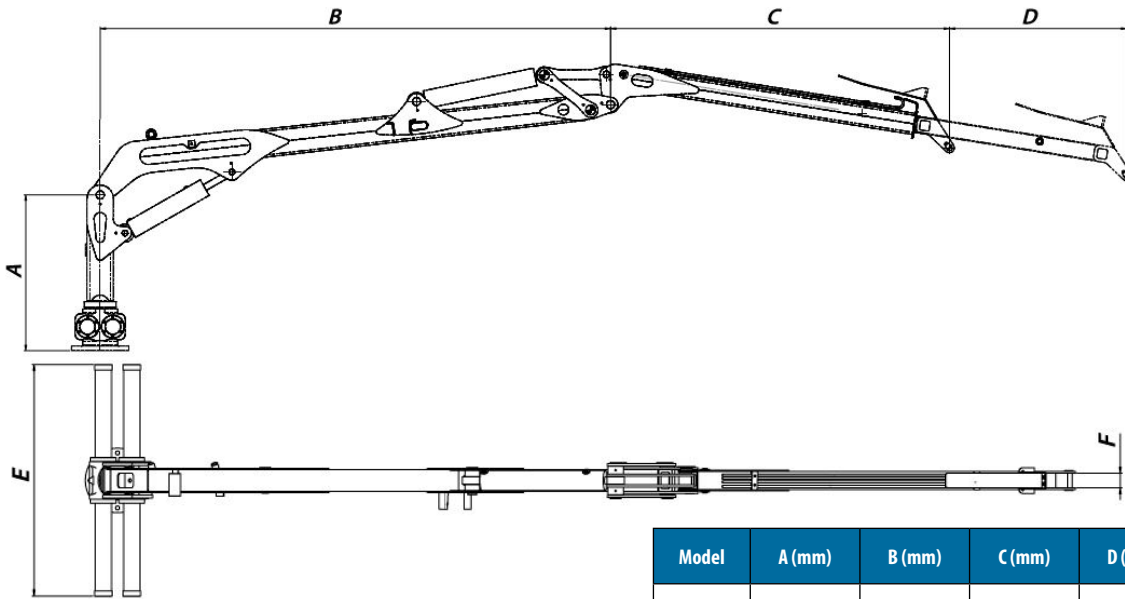

Model	A (mm)	B (mm)	C (mm)	D (mm)	E (mm)	F (mm)
C6.7 G3	1 445	3 245	2 075	1 455	1 270	80

* All dimensions in the figures are in mm. Numbers can be rounded off to the nearest whole number. We reserve the right to alter specifications without prior notice. Figures for the measurements are for illustrative purpose only. For additional information about crane sizes, movement patterns and specifications please refer to the matrix and technical data in this brochure and to www.forsmw.com, where detailed information is available.

MAIN DIMENSIONS

	T9 F	T9 F 4WD	T10 F	T10 F 4WD	T10 G2
Gross weight (kg)	9 000	9 000	10 000	10 000	10 000
Load area (m ²)	2.1	2.1	2.2	2.2	2.3
Wheel dimensions	400/60-15.5	400/60-15.5	500/50-17	19/45-17	500/50-17
Standard trailer weight (kg)	1 640	2 500	1 740	2600	1 935
Steering angle frame steering (degrees)	48	48	48	48	52

	T9 F	T9 F 4WD	T10 F	T10 F 4WD	T10 G2
A, mm	5 400	5 400	5 400	5 400	5 680
B, mm	3 495 - 3 945 *				3 655-4 110*
C, mm	990	990	1 130	990	1 130
D, mm	520	525	515	530	515
E, mm	1 140	1 145	1 135	1 150	1 195
F, mm	2 065	2 070	2 060	2 075	2 290
G, mm	1 230	1 230	1 230	1 230	1 225
H, mm	3 565	3 600	3 750*	3600	3 745
I, mm	2 205 - 2 655*	2 205 - 2 655*	2 205 - 3 095*	2 205 - 2 655*	2 320 - 2 775*
J, mm	2 135	2 135	2 310	2 325	2 325
K - Ground clearance, mm	530	505	510	510	525
L, mm	1 970	1 970	2 125	2 125	2 140

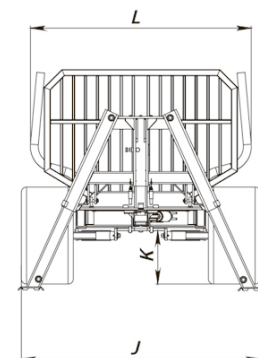
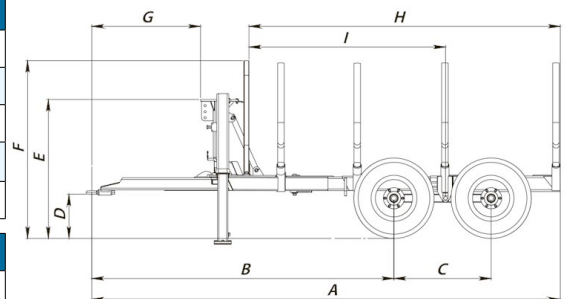

*Adjustable dimensions.

T9F/T9F 4WD/T10F 4WD is also possible to order with C6.3

Figures for the measurements are for illustrative purpose only. We reserve the right to alter specifications without prior notice. Numbers can be rounded off to the nearest whole number.